

BEARINGS – BEARINGS REGREASERS



HEIM ROD ENDS MALE THREADED M AND HM SERIES

Rod Ends male threaded (HM M Series)

• Outer Member: Aircraft Quality Carbon Steel, Magnetic particle inspected, with protective coating for corrosion resistance. • Ball: 52100 Alloy Steel, heat treated, chrome plated. • Inserts: Brass, 16 size has one piece carbon steel race.

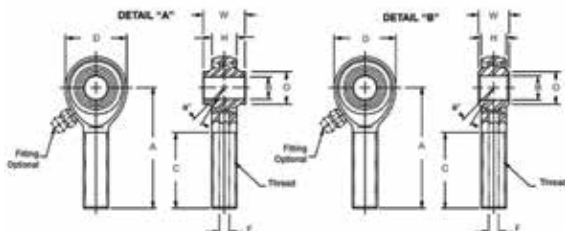

Heim "M" and "MD" series bearings are now manufactured in magnafluxed version only. As old stock is depleted, magnafluxed equivalents will be furnished as substitutes at current (higher) prices unless otherwise requested on the order.

"L" in rod end number designates left hand thread. In this series, the "D" in rod end number (MD35 14) denotes drilled hole in the shank. Add suffix "G" to indicate lubricator is required. Example: HM-SG. Add suffix "FG" to indicate flush type lubricator is required. Example: M34-14FG. Lubricator (G) (FG) available with minimum qty. required. Please Call for Pricing.

Rod End No.	Equiv. Sphero No.	DIMENSIONS											Max Static Radial Load in Pounds Approx.	Approx. Weight in Pounds	Price Each
		Bore	Ball Width	Housing Width	Ball Flat Diam.	Head Diam.	Length to center of ball	Overall Length	Other Dimensions						
		B	W	H	O	D	F	G	A	N	Ball Diam.	M			
		+0.0015 -0.0005	+0.000 -0.005	+0.005 -0.005		+0.010 -0.010	+0.010 -0.010	+0.010 -0.010	Min	Drill Diam.		Class 3A			
M34-14M	NONE	.1900	.437	.328	.273	.750	1.560	1.935	1.000		33/64	1/4"-28	1,695	.05	---
MD35-14M	NONE	.1900	.437	.328	.273	.875	1.375	1.812	.750	#33	33/64	5/16"-24	2,184	.07	---
MDL35-14M										.113		UNF			---
MD36-14M	NONE	.1900	.437	.328	.273	.750	1.375	1.750	.750	#33	33/64	3/8"-24	2,848	.07	---
MDL36-14M										.113		UNF			---
MD36-16M	NONE	.1900	.500	.375	.321	.812	1.812	2.219	1.062	#29	19/32	3/8"-24	2,769	.08	---
MDL36-16										.136		UNF			---
M44-14	NONE	.2500	.437	.304	.354	.812	1.562	1.968	1.000		9/16	1/4"-28	1,695	.06	---
ML44-14												UNF			---
MD46-15	NONE	.2500	.484	.335	.395	.875	2.312	2.750	1.500	#29	5/8	3/8"-24	3,151	.10	---
MDL46-16										.159		UNF			---
HM-2M	NONE	.1250	.250	.187	.187	.469	.937	1.172	.500		5/16	6-32	452	.02	---
HM-2AM	NONE	.1562	.281	.219	.249	.562	1.125	1.406	.625		3/8	8-32	666	.02	---
HML-2AM												UNC			---
HM-3M	TRE-3	.1900	.312	.250	.306	.625	1.250	1.563	.750		7/16	10-32	910	.03	---
HML-3M	TREL-3											UNF			---
HM-4M	TRE-4	.2500	.375	.281	.355	.750	1.562	1.937	1.000		33/64	1/4"-28	1,695	.05	---
HML-4M	TREL-4											UNF			---
HM-5M	TRE-5	.3125	.437	.344	.447	.875	1.875	2.312	1.250	#33	5/8	5/16"-24	2,205	.08	---
HM-6M	TRE-6	.3750	.500	.406	.517	1.000	1.938	2.438	1.250	#21	23/32	3/8"-24	3,172	.11	---
HML-6M	TREL-6									.159		UNF			---
HM-7M	TRE-7	.4375	.562	.437	.586	1.125	2.125	2.688	1.375	#21	13/16	7/16"-20	4,633	.16	---
HML-7M	TREL-7									.159		UNF			---
HM-8M	TRE-8	.5000	.625	.500	.698	1.312	2.438	3.094	1.500	#3	15/16	1/2"-20	5,876	.24	---
HML-8M	TREL-8									.213		UNF			---
UNF= Universal Fine, UN=Universal Coarse															

UNF= Universal Fine, UN=Universal Coarse



ACS BEARING REGREASERS

The ACS bearing regreasers restore bearings, rod ends and pulleys to like-new condition. O-ring in base of regreaser provides positive seal when bearing is secured by the threaded center post. Grease, entering under pressure at the grease fitting, is forced to flow through the bearing, flushing out the old grease and dirt, and recharging the bearing with fresh grease.

Available in five sizes.

Non-Anodized

Made in USA

Bearing Regreaser No.	Part No.	Bearing Size		Price Each
		O.D.	Bore	
3	10650-3	3/4"	3/16"	---
4	10650-4	1"	1/4"	---
5	10650-5	1-1/4"	5/16"	---
6	10650-6	1-1/2"	3/8"	---
8	10650-8	1-1/2"	1/2"	---

Complete Set of Five - P/N 12-11500