

CRANKCASE, ROTARY VALVE DRIVE, WATER PUMP

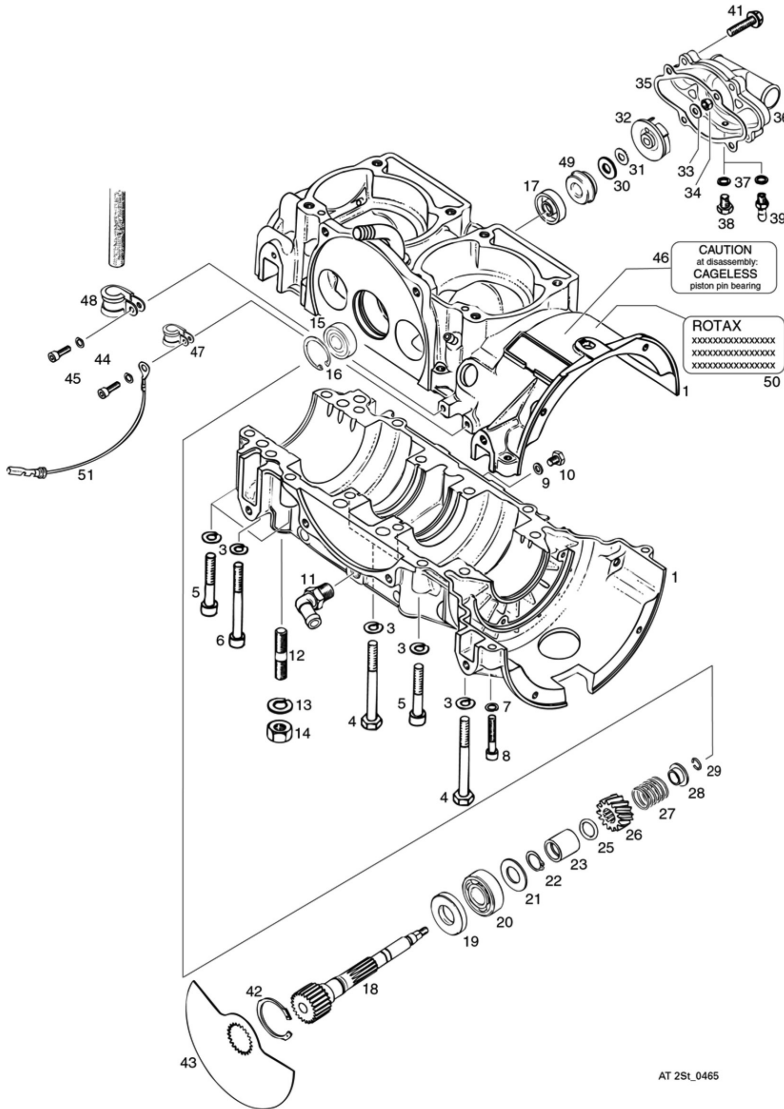

Item No.	Part No	Description	Qty. Req.		Price
			mod. 99	mod. 17	
1-12	888-471	CRANKCASE-ASSEMBLY	1	1	\$1,435.29
1-29,42	888-476	CRANKCASE-ASSY. W/ROTARY VALVE DRIVE	1c	1c	\$1,596.91
3	945-752	LOCK WASHER A8	14	14	\$0.21
3	945-832	LOCK WASHER A8	14	14	\$0.23
4	841-302	HEX. SCREW M8x65	6	6	\$1.97
5	841-562	ALLEN SCREW M8x45	6	6	\$4.43
6	841-832	ALLEN SCREW M8x75	2	2	\$3.32
7	945-751	LOCK WASHER A6	2	2	\$0.21
8	241-811	ALLEN SCREW M6x35	2	2	\$0.57
9	230-415	GASKET RING A6x10	1	1	\$1.40
10	240-772	HEX. SCREW M6x10	1	1	\$0.63
11	922-242	ANGULAR TUBE 1/4-18NPT	1	1	\$18.14
12	940-190	STUD M10x29/20	4	4	\$4.78
13	945-833	LOCK WASHER A10	4	4	\$0.34
14	242-092	HEX. NUT M10	4	4	\$1.38
15	932-797	BALL BEARING 6201-Z, 12-32-10	1	1	\$26.49
16	245-420	RETAINING RING	1	1	\$2.07
17	850-711	OIL SEAL 10x30x8	1	1	\$23.31
18	837-250	ROTARY VALVE SHAFT	1a	1a	\$202.77
19	930-580	OIL SEAL 20x40x7	1	1	\$24.71
20	932-032	BALL BEARING 6203 TVH C3, 17-40-12	1	1	\$32.93
21	227-439	SHIM 17.2/32.5/1.5	1	1	\$4.42
22	845-450	RETAINING RING 17x1	1	1	\$1.23
23	847-282	SPACER	1	1	\$14.78
24	927-440	SHIM 15.1/22.5/0.5	x	x	\$1.92
25	831-500	O-RING 14-3	1	1	\$4.85
26	935-736	ROTARY VALVE GEAR 14 T.	1	1	\$101.54
27	938-810	COMPRESSION SPRING 25.1 MM (0.99 IN)	1	1	\$9.27
28	827-430	SPRING HOLDING CUP	1	1	\$11.91
29	845-160	CIRCLIP 12	1b	1b	\$1.71
30	227-945	THRUST WASHER 8.1/15/0.5	1	1	\$1.92
31	227-155	FRICITION WASHER	1	1	\$9.83
32	922-036	IMPELLER	1	1	\$23.29
33	244-211	WASHER 6.4	1	1	\$0.21
34	842-042	LOCK NUT M6	1	1	\$2.66
35	831-616	GASKET	1	1	\$9.13
36	922-503	WATER PUMP HOUSING	1	1	\$253.77
37	230-415	GASKET RING 6.2/8.9/1	1	1	\$1.40
38	841-580	HEX. SCREW M6x8	1	1	\$0.57
39	940-551	HOSE NIPPLE M6	1	1	\$17.20
40	244-211	WASHER 6.4	x	x	\$0.21
42	945-880	RETAINING RING 40x1.75	1		\$3.19
43	924-504	ROTARY VALVE 132 DEGR.	1	1	\$67.19
44	945-750	LOCK WASHER A5	2	2	\$0.14
45	840-514	ALLEN SCREW M5x16	2	2	\$0.53
46	897-280	CAGELESS-LABEL	1	1	\$1.76
47	851-111	CABLE CLAMP 8/M5	1	1	\$12.46
48	851-113	CLAMP 18/M5	1	1	\$11.71
49	650-370	ROTARY SEAL	1	1	\$45.42
50	897-501	RED WARNING LABEL	1	1	\$6.61

- Items not illustrated

- a Rotary valve for configuration with rotary seal
- b The circlip must be positioned at the inner groove only
- c Crankcase including rotary valve drive, configuration with rotary seal